

4051-

Have not rec. your sketch of Date St Entrance -

Tell JUL 29 1911 JCU

OLMSTED BROTHERS

RECEIVED

Dear Mr. Olmsted -

JUL 28 2 34 PM sending to night under

separate cover to night a blue print showing a study only partially completed - of suggested treatment

of Date St Entrance and bridge to central mesa - and bridge across Spanish Canyon to central Park Boulevard -

Allen suggested and urged a bridge - further north across the Spanish Canyon -

so then we concurred the idea to have it start a point projected on the N. & S. line (axis) of the main court -

~~Then~~ I then studied ~~an~~ some thing for the treatment of the Date St entrance and the connections thru into of the long bridge and the two entering drives - and I have agreed to recommend the ~~at~~ this arrangement with modifications

ACK'D BY JCU  
ANS'D 28/7 BY JCU

READ BY

to you — I <sup>was</sup> anxious to get <sup>(2)</sup>  
this print off to you to night —  
so have not given it the amount of  
study it should have — in fact I  
already see that to save fill and  
to get cut material — the Spanish  
Canyon bdy should be moved at  
least its own width further  
north — and the drains on the central  
Mesa W. of Spanish Bdy should be  
lowered to get material —

The south ~~end~~ portion of the  
Date St Plaza — main seems to  
narrow — with only 35' roads  
on each side of a central 60 parking  
I had these roads 50' wide first and  
then thought that the side walls  
on the south side of Date St going  
to the water would have to remain so  
have shown a platg strip 15' wide  
out side of the present curb —

If we make these two roads 50' wide -  
 I am ~~feared~~ <sup>proportion of</sup> it will shorten too much  
 the long plaza going north -  
 perhaps not - This need more study  
 but what I am anxious ~~for~~ to do  
 is to establish and get your approval  
 in general of the plaza and more  
 especially the location of the long  
 bridge across Cabrillo Canyon -  
 The blue print is poor - I am sorry -  
 and will be hard for you to see  
 easily - grade  $\frac{1}{2}$  of approach from  
 N. end of long Plaza to bridge  
 2-3% - grade of bridge 2% -  
 grade <sup>at</sup> on N. E. end of Cabrillo  
 Bldg - to lot of drive to Spanish Bldg  
 3% - 4% and 5% - This should be  
 lessened ~~and~~ to get material -  
 Cabrillo Bldg 55' long - not including  
 the walls retaining a 15' fill at  
 each end - which has been allowed

at each end of both bridges — (4)

The Spanish Canyon Bldg as now proposed is certainly more interest in going to the South end of Park not so bad if going to green house and h. of same — ~~It~~ It comes in good relation to the N. end of the Exposition — and seems to ~~hit in a more central part of the avenue~~ ~~and~~ hit the Central Park Blvd. better than at the W. side of the Art Bldg — It is nearer to the proposed dam — and perhaps too near (740') Please notice that I have changed slightly the present west drive where it enters the N. end of the long plaza — Blossom proposed a band stand and concert grove — west of the long N. & S. Plaza — at Doto St entrance —

Lately Allen has been - wanting a double road on the central mesa with bldgs (french like) on each side of same and one or more at the end -

have objected to it all a long although he would insert on having Blossom make sketches for same -

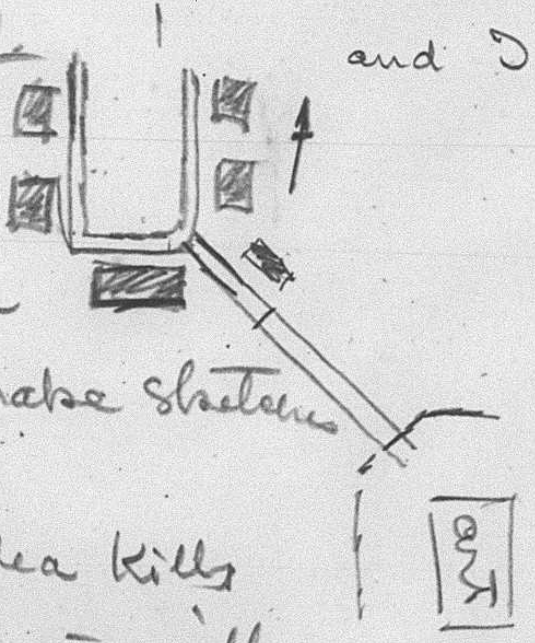

This new bridge idea kills that and now he is willing to have the U.S. Govern. Bldg on the west of the west end of the Spanish bridge as now proposed - facing the exposition on the long axis of this bridge - I don't know why he should have anything to say about it - but you know he ~~does~~ takes it upon him self.

⑥

Spanish Bridge as now proposed  
355' long - grade level - ②10  
will be slightly longer if it is moved  
it own width north and it may  
be that the el. can be raised to 212±  
from 210 as shown - This will  
increase cost - may be too much  
but it lessen grade of road between  
E. end and Park Baul. (axis of Exp.)

Conclusion.

If you agree in general - of  
moving the Spanish bridge north  
as shown with modifications of course  
also to the location of the Caballo.

# Brdg -

also to the long plaza arrangement  
connecting Date St.

Please wire me - and then  
we can start on estimates -  
and I can begin to think of getting  
away

I still want to get a piece of  
 straight road at south end  
 Entrance main entrance to Expositi-  
 and I dont like the location of  
 the service Bldg ~~as~~ if left  
 permanent and paid for by the  
 Park - it seems O.K. for Exposition  
 but not for Park - and allen says  
 the Park Bsd is to pay for it -  
 what do you think -

Hastily and faithfully yours  
James F. Dawson

Good luck gets here July 26<sup>th</sup>